

## Product info sheet

Delphi

28334239

Special tools needed?

Yes

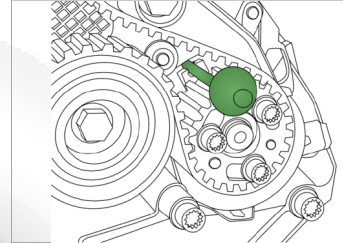

## Product specific information

Programming

No

Unlocking

No

Adaption values reset

No

Bleed

Yes

adjustment at mounting\_1

Yes

Respect timingmark pumpsprocket because of pressure-pulse timing

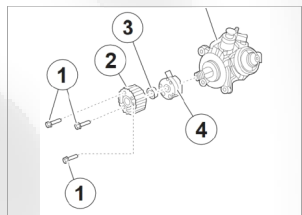
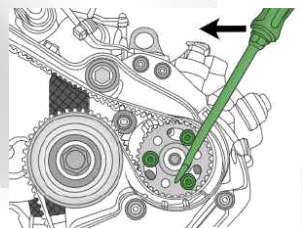

adjustment at mounting\_2

## Tightening torques

Pump shaft nut

95 Nm

Pump pulley/sprocket

20 Nm + 90°

Mounting fuelpump flange

Long bolts 20 Nm +180°, short bolt 20 Nm + 45°

## Assembly instructions

Replace tension bolts

Recommendation: replace fuel filter

### Core charge terms:

- externally intact,
- no mechanical damage,
- not dismantled,
- no heavy corrosion.